

## SOCKET MOUNT ADAPTOR KIT - PRODUCT REF: SA410A

### CONTAINS:

- 4 X M16 x 25 HEX BOLTS (Galv)
- 4 X M16 FLAT WASHERS Galv
- 1 X SA410 187mm SOCKET MOUNT ADAPTOR
- 1 x WE001 LOCKING WEDGE (not required for direct cement in)

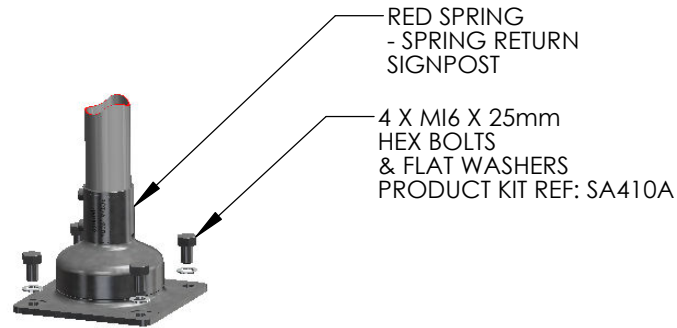

RED SPRING  
- SPRING RETURN  
SIGNPOST

4 X M16 X 25mm  
HEX BOLTS  
& FLAT WASHERS  
PRODUCT KIT REF: SA410A

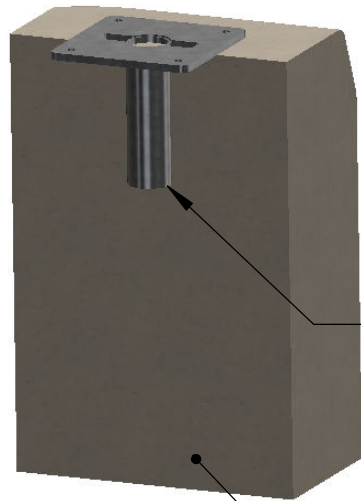

SOCKET MOUNT ADAPTOR  
PRODUCT KIT REF: SA410A

10MPa Concrete

PREFERREED POST OREINTATION  
FOR DIRECTION OF TRAFFIC

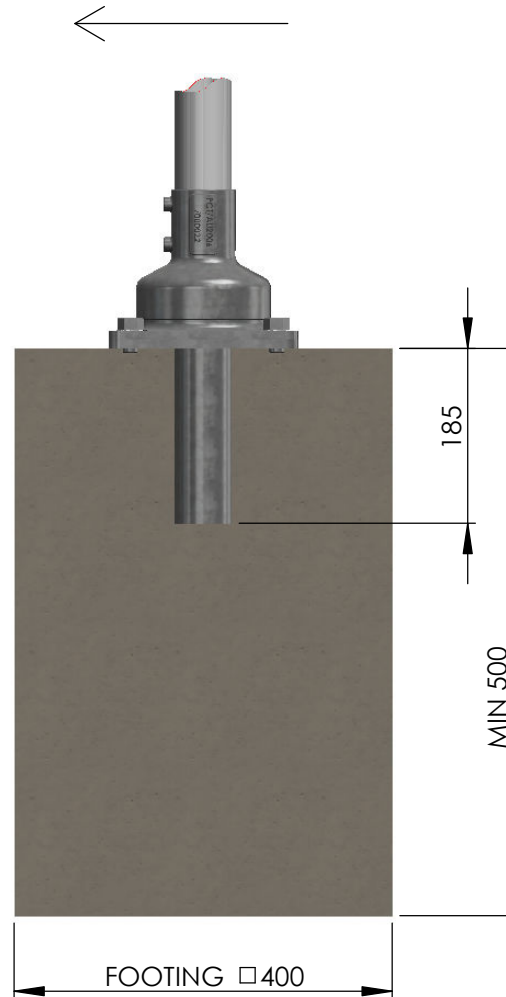

SOCKET MOUNT ADAPTORS CAN BE INSTALLED DIRECTLY INTO A CONCRETE FOOTING. IF DOING THIS IT IS RECOMMENDED TO FLATTEN THE END OF THE TUBE A SMALL AMOUNT WITH A HAMMER TO INHIBIT ANY CHANCE OF ROTATION

### INSTALLING SOCKET MOUNT ADAPTOR:

please refer to standard installation specifications produced by road authorities in your region as soil conditions and specifications may be different. This information is intended as a guide and any local authority specifications should will take precedence.

### FOOTING:

If installing a new footing we recommend a minimum of 400mm square by 500mm deep. Allow at least 50mm beneath the gorund socket.

### GUIDELINES FOR INSTALLING:

(Local regulations should always take precedent over these installation guidelines)

PRODUCT REF : SA410A

1. ORIENTATE AND SET SOCKET MOUNT ADAPTOR INTO FOOTING
2. CONCRETE ADAPTOR IN PLACE USING MIN 10MPa CONCRETE
3. LEAVE CONCRETE TO SET BEFORE FITTING THE SPRING RETURN SIGN POST
4. BOLT THE SPRING RETURN SIGN POST TO THE SOCKET MOUNT ADAPTOR AND TIGHTEN DIAGONALLY

**INFORMATION APPLICABLE TO:  
SURFACE MOUNT - SPRING RETURN SIGN POST UNIT  
- RED SPRING**

SCALE	NTS
CHECKED	ICB
LAST UPDATE	4/02/2016
DRAWN	Ian Brodie
DATE	06/05/2011

ALL DIMENSIONS IN MILLIMETERS	QUANTITY	DO NOT SCALE IF IN DOUBT ASK
MATERIAL	NA	
FINISH	NA	1
DESCRIPTION	TALL SPRING RETURN SIGNPOST TECHNICAL INFORMATION SHEET 11 SOCKET MOUNT ADAPTOR - DIRECTLY CONCRETE INTO FOOTING INSTALLATION GUIDELINES	

### JMB MANUFACTURING PTY LTD

24 BRIGID BOULEVARD  
AUSTINE HEIGHTS  
QLD AUSTRALIA 4300  
PH. 07 3814 7882  
FAX. 07 3814 7884



ACAD FILE NAME  
Technical Information 27-06-2014

SH. 9

Part:

OF 13